

 News · 17th Jun 2019

Chalegrove's Landmark Pinnacle tops out

75-storey, 752-unit tower in Canary Wharf will round-off the developer's trilogy of 'Landmark' schemes



Chalegrove Properties has hit a key construction milestone at its flagship Landmark Pinnacle scheme in Canary Wharf.

Designed by Squire & Partners, the 75-storey tower has now reached its full height of 239 metres (784 feet), and is well on its way to delivering 752 new apartments, with a completion target of Q3 2020. Floorplates range from 426 to 1,171 square feet, and each unit will have a winter garden or “amenity area”.

The residents’ gym, double-height private roof terrace and upper-level apartments will all be the highest in the capital, but the one of the key selling points is to be found down on the 27th floor: an indoor version of the traditional London garden square.



Other amenities include a cinema room, golf simulator, putting green, table tennis room, two arcade rooms with snooker tables, lounge and relaxation rooms, meeting facilities and two private dining areas complete with service kitchens.

The scheme will round off the developer's trilogy of "Landmark" projects: Landmark East, Landmark West and Landmark Pinnacle.

Ian Spencer-Woodbridge, Project Manager at Chalegrove Properties: "The topping-out of Landmark Pinnacle is a momentous occasion for Chalegrove Properties and the construction programme. This accomplishment is a testament to the teams involved with the project, at every level, who have put in a tremendous amount of hard work and effort into reaching this stage. It's fantastic to see Landmark Pinnacle take its final shape and make a prominent mark on Canary Wharf."

IN PICTURES: LANDMARK PINNACLE, CANARY WHARF (Chalegrove Properties/Squire & Partners)

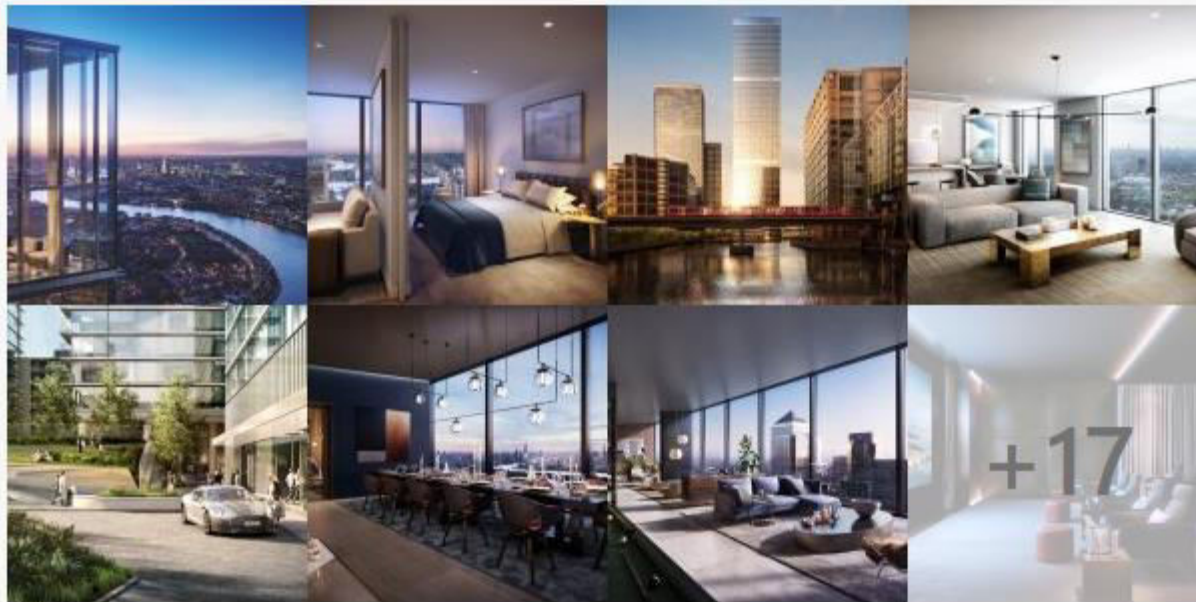

landmarkpinnacle.co.uk